

System BM1.1 Exposed roof with bituminous waterproofing membrane (insulated)					
NO	LAYER	MATERIAL	THICKNESS [mm]	POSSIBLE ALTERNATIVE	NOTE
1	Structure	Reinforced concrete slab		Concrete and masonry slab, precast concrete elements, corrugated metal sheet with concrete slab	Substrate with adequate slope. For discontinuous substrates must be realized adequate "pontage"
2	Bituminous primer (*)	IDOPRIMER	0,1	POLYPRIMER HP 45 Pro	
3	Vapour barrier layer	POLYVAP RADONSHIELD 3 mm	3	POLYVAP FIX AL 3,5 mm	
4	Thermal insulation layer	PUR VB	30 40 50 60 70 80 100 120 140 160	PUR/PIR according to EN 13165 with bituminous coating	Panels must be mechanically fixed or bonded
5	Waterproofing membrane first layer	POLYFLEX LIGHT 4 mm	4		
6	Waterproofing membrane second layer	POLYFLEX LIGHT MINERAL 5 mm	5		

(*) Apply the product according to the thickness specified in the table. In the layout designed using Autodesk Revit software, the same product has been integrated into the next layer because the minimum representable thickness is 0.8 mm.

For information on the characteristics and how to use the aforementioned products, please refer to the latest version of the relative Technical Data Sheets which are available on our website www.polyglass.com.

Section

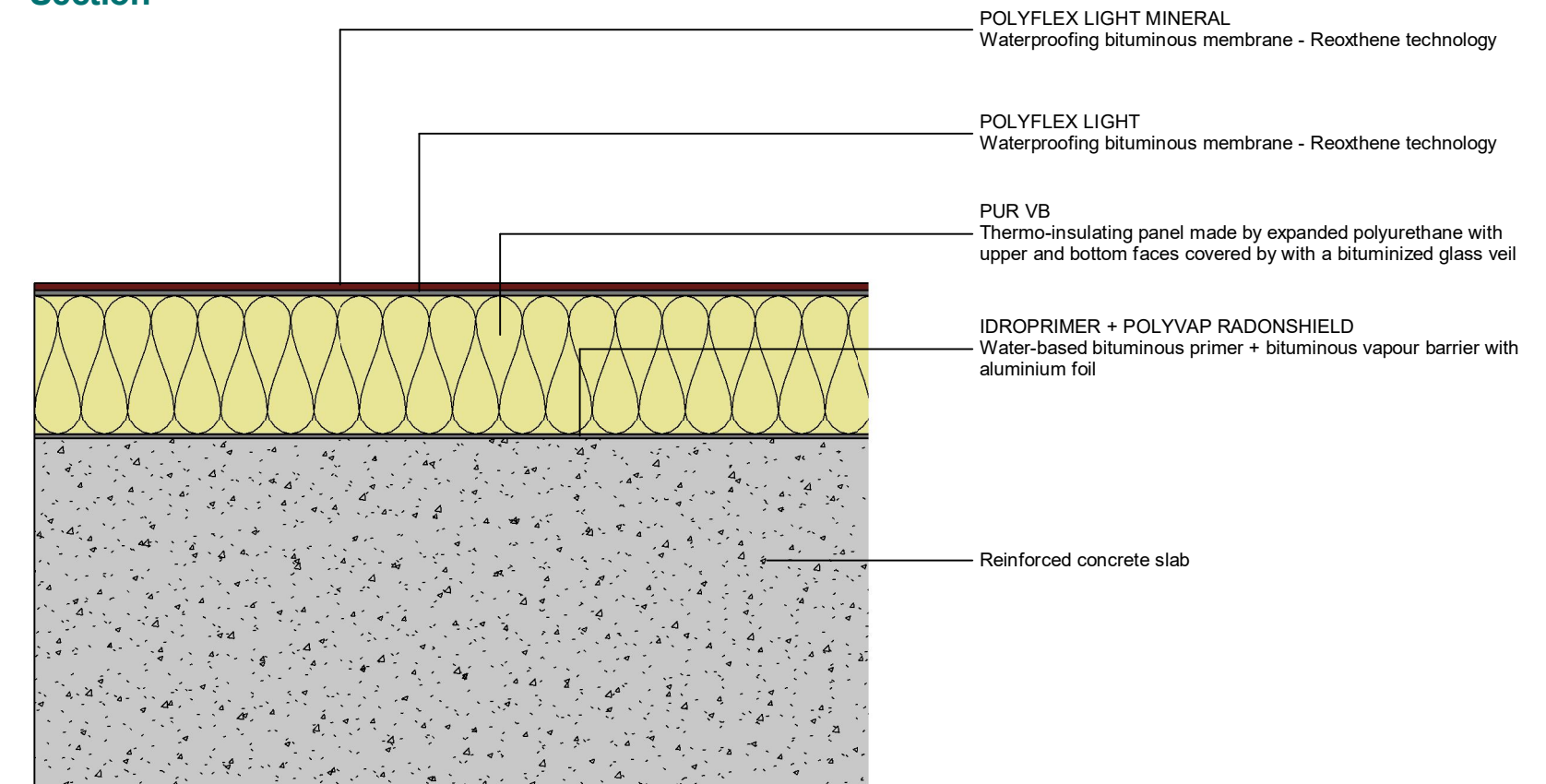

Build-up composition

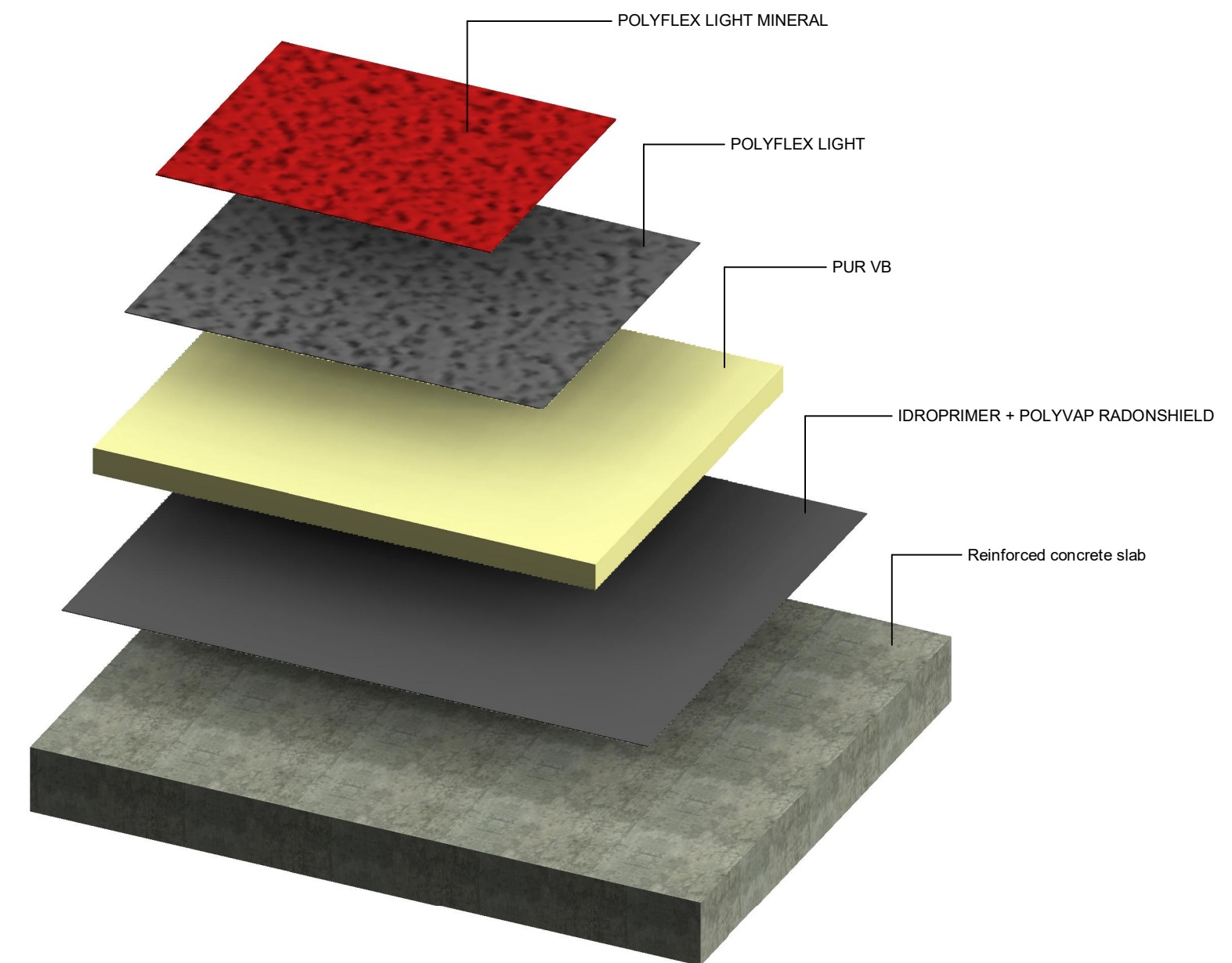

System BM1.1

Exposed roof with bituminous waterproofing membrane (insulated)

Please note that it is the user's responsibility to verify the accuracy of the values supplied by Revit for composite packages and, in all cases, Polyglass only guarantees the accuracy of the data and figures for materials/products manufactured by Polyglass.



Adds value!

POLYGLASS SPA
Registered Office: Viale Jenner, 4 - 20159 MILANO
Head Office: Via dell'Artigianato, 34 - 31047 Ponte di Piave (TV) - Italy
Tel. +39 04227547 - Fax +39 0422854118 - www.polyglass.com - info@polyglass.it