

**Section**

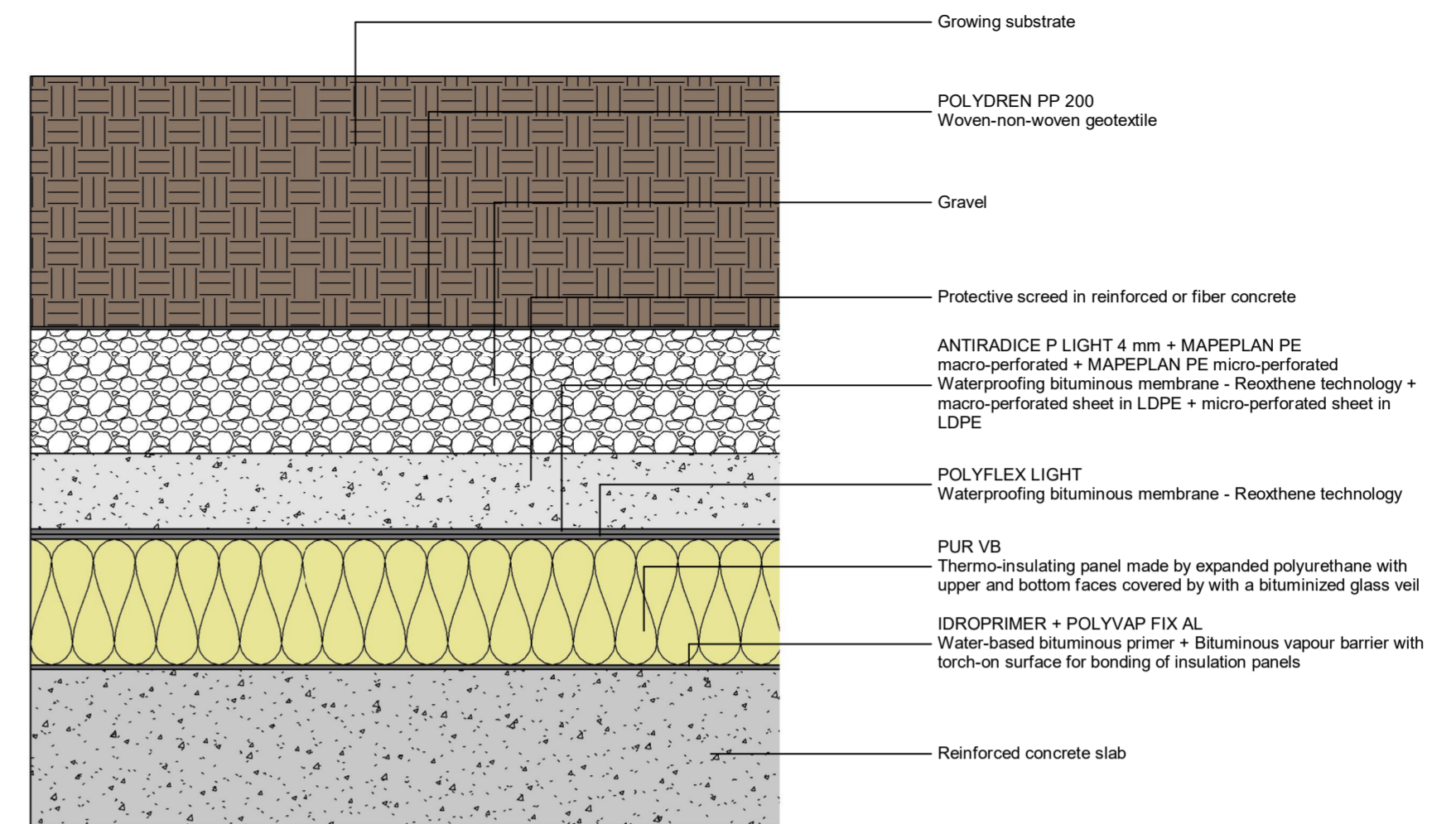

**System BM6.1**  
Green roof with bituminous waterproofing membrane (insulated)

NO	LAYER	MATERIAL	THICKNESS [mm]	POSSIBLE ALTERNATIVE	NOTE
1	Structure	Reinforced concrete slab		Concrete and masonry slab, precast concrete elements, corrugated metal sheet with concrete slab	Substrate with adequate slope
2	Bituminous primer (*)	IDROPRIMER	0,1	POLYPRIMER HP 45 Pro	
3	Vapour barrier layer	POLYVAP FIX AL 3,5 mm	3,5	POLYVAP RADONSHIELD 3 mm	
4	Thermal insulation layer	PUR VB	30 40 50 60 70 80 100 120 140 160	PUR/PIR according to EN 13165 with bituminous coating	Panels must be bonded
5	Waterproofing membrane first layer	POLYFLEX LIGHT 4 mm	4		
6	Waterproofing membrane second layer (anti-root)	ANTIRADICE P LIGHT 4 mm	4		
7	Separation layers (*)	MAPEPLAN PE macro-perforated + MAPEPLAN PE micro-perforated	0,15 + 0,1		
8	Protective screed	Protective screed in reinforced or fiber concrete			
9	Drainage layer	Gravel		Expanded clay, geocomposite drainages	
10	Filter layer	POLYDREN PP 200	2		
11	Soil	Growing substrate			

**Build-up composition**

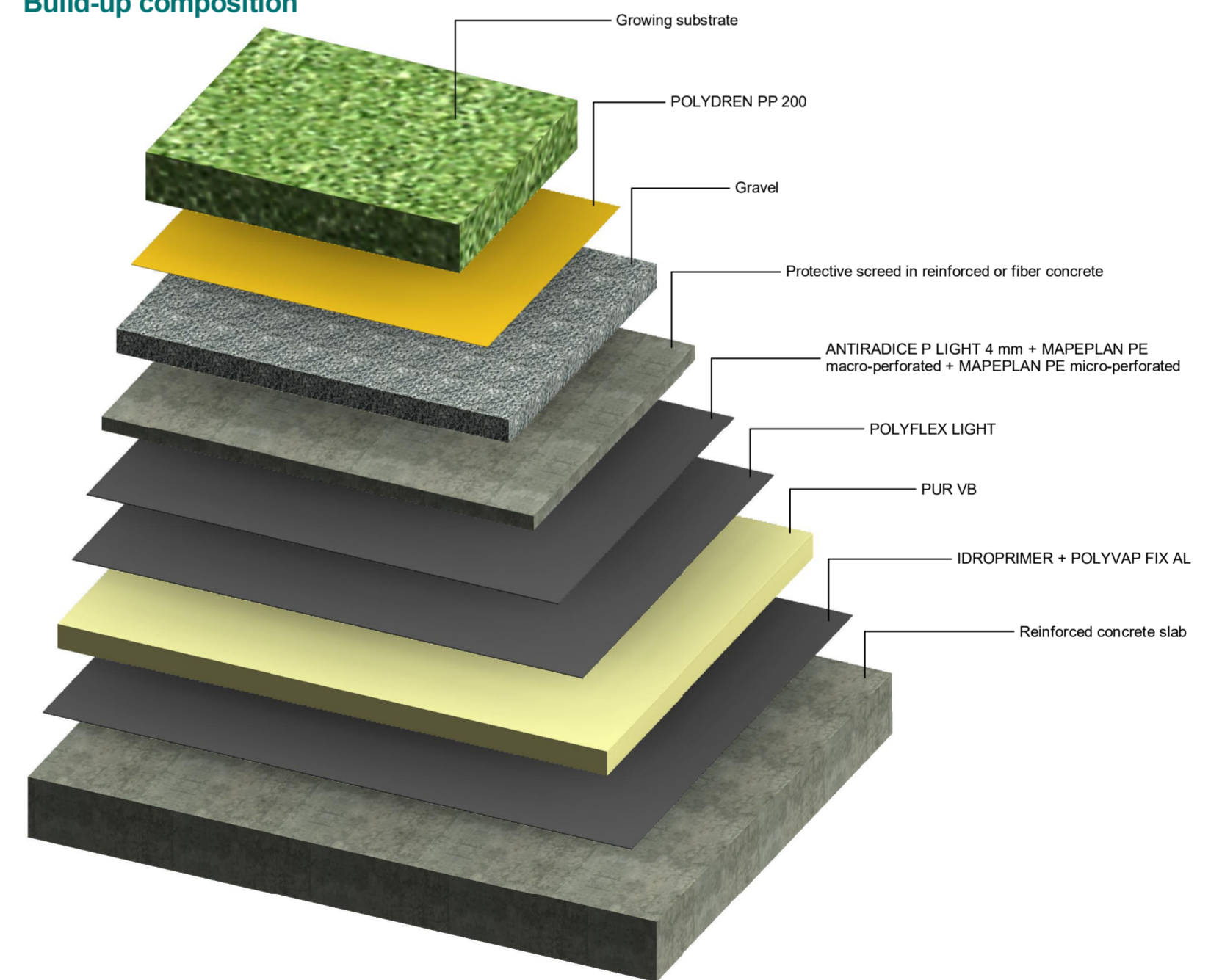

(\*) Apply the product according to the thickness specified in the table. In the layout designed using Autodesk Revit software, the same product has been integrated into the next layer because the minimum representable thickness is 0.8 mm.

For information on the characteristics and how to use the aforementioned products, please refer to the latest version of the relative Technical Data Sheets which are available on our website [www.polyglass.com](http://www.polyglass.com).

# System BM6.1

## Green roof with bituminous waterproofing membrane (insulated)

Please note that it is the user's responsibility to verify the accuracy of the values supplied by Revit for composite packages and, in all cases, Polyglass only guarantees the accuracy of the data and figures for materials/products manufactured by Polyglass.



*Adds value!*

**POLYGLASS SPA**  
Registered Office: Viale Jenner, 4 - 20159 MILANO  
Head Office: Via dell'Artigianato, 34 - 31047 Ponte di Piave (TV) - Italy  
Tel. +39 04227547 - Fax +39 0422854118 - [www.polyglass.com](http://www.polyglass.com) - [info@polyglass.it](mailto:info@polyglass.it)