

Section

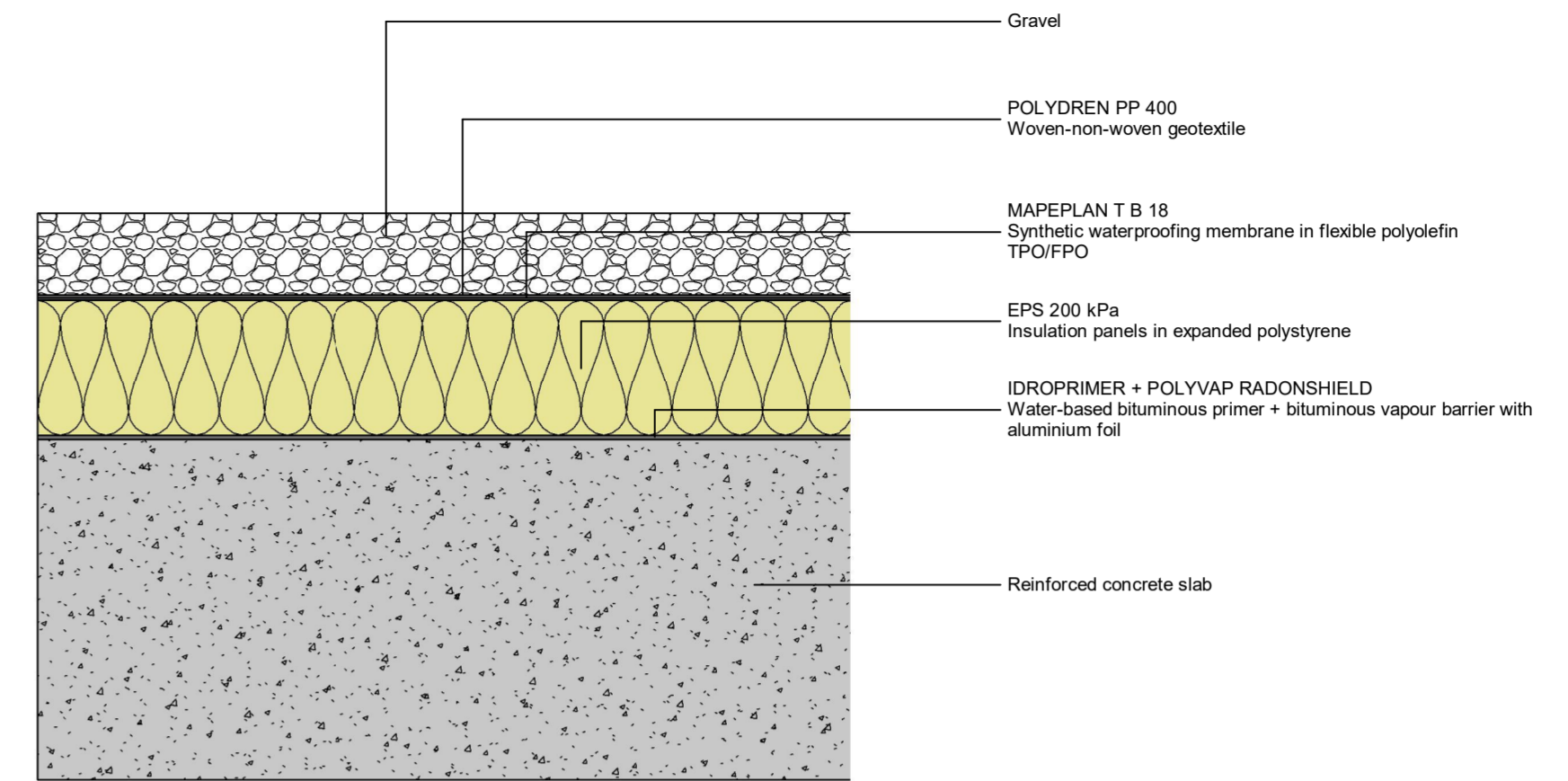

Build-up composition

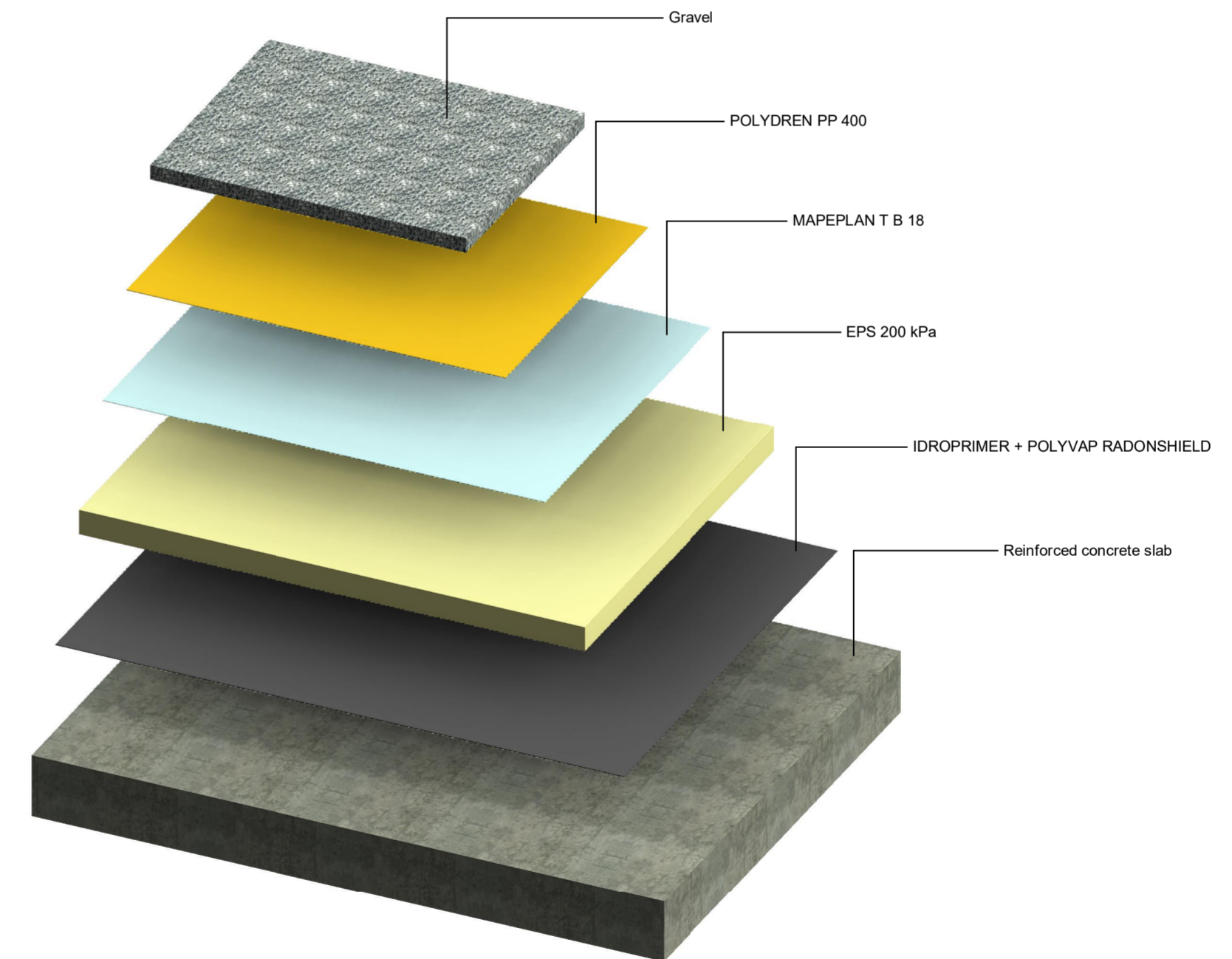

System TB1.1
Ballasted roof with TPO/FPO synthetic waterproofing membrane (insulated)

NO	LAYER	MATERIAL	THICKNESS [mm]	POSSIBLE ALTERNATIVE	NOTE
1	Structure	Reinforced concrete slab		Concrete and masonry slab, precast concrete elements, corrugated metal sheet with or without concrete slab, wood	Substrate with adequate slope
2.1	Bituminous primer (*)	IDROPRIMER	0,1	POLYPRIMER HP 45 Pro	
2	Vapour barrier layer	POLYVAP RADONSHIELD 3 mm	3	POLYVAP SA 2 mm PLANA P 3 mm POLYVAP FIX AL 3,5 mm	
3	Thermal insulation layer	EPS 200 kPa according to EN 13163	30 40 50 60 80 100 120 140 160 180 200	EPS 150 kPa according to EN 13163; XPS 300 kPa according to EN 13164; PUR/PIR according to EN 13165	
4	Waterproofing membrane	MAPEPLAN T B	1,5 1,8 2,0		
5	Protection layer	POLYDREN PP 400	2,2	POLYDREN PP 300	
6	Ballast layer	Gravel		Expanded clay, floating pavement	

(*) Apply the product according to the thickness specified in the table. In the layout designed using Autodesk Revit software, the same product has been integrated into the next layer because the minimum representable thickness is 0.8 mm.

For information on the characteristics and how to use the aforementioned products, please refer to the latest version of the relative Technical Data Sheets which are available on our website www.polyglass.com.

System TB1.1

Ballasted roof with TPO/FPO synthetic waterproofing membrane (insulated)

Please note that it is the user's responsibility to verify the accuracy of the values supplied by Revit for composite packages and, in all cases, Polyglass only guarantees the accuracy of the data and figures for materials/products manufactured by Polyglass.



Adds value!

POLYGLASS SPA
Registered Office: Viale Jenner, 4 - 20159 MILANO
Head Office: Via dell'Artigianato, 34 - 31047 Ponte di Piave (TV) - Italy
Tel. +39 04227547 - Fax +39 0422854118 - www.polyglass.com - info@polyglass.it